

Parameter

Approved : CE / FCC / RoHS

Contact type : NC——Switch ON when magnet nearby

Operating gap : $\geq 25\text{mm}$ (Undisturbed test)

Max. switching voltage : 100V DC/AC

Max. switching current : 0.5A

operating load : 10W

Working temperature : $-20\sim 80^{\circ}\text{C}$

Working life : >100000 times

Connection type : 2 Pin terminal

Material : ABS

Color : White / Brown

Packaging : 10 sets/bag , 600 sets/ctn

G.W. : 10KGS

Dimension (mm) :

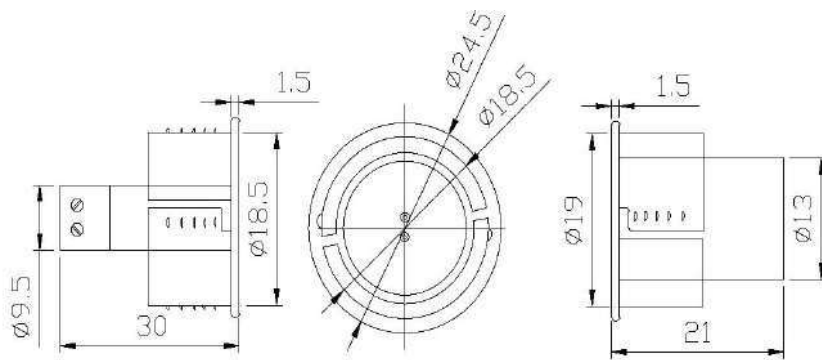

Installation drawing

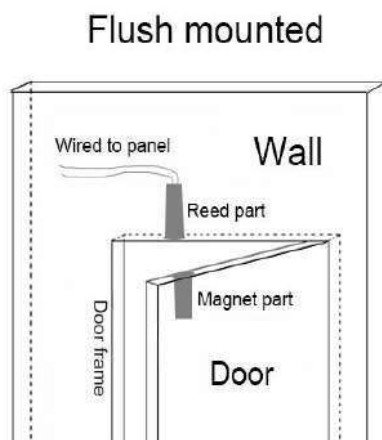

Introduction

Magnetic contact is widely used for alarm system(panel) to detect state of door. It consist of a reed switch part and a magnet part . When door closed, reed switch is effected by magnet and turn ON; when door open, reed switch is effected by magnet and turn OFF, trigger alarm.

Installation instruction

Surface/Roller shutter mounted should be fixed with screw or double faced tape.

Flush mounted should be fixed in the hole between the door and door frame. Magnet part install on the edge of door, reed part install on the edge of door frame as close to magnet part as possible .

Wired reed part to alarm system (panel).

Warning

Do not knock reed part when mounting.

Magnetic contact should be used for doors/windows alarm only, please contact us for technical parameters confirming if used as a equipment switch.

* Weight and Size are Only Approximation and May be Modified Without Prior Notification.



DCB036-Series

The DCB036-Series recessed mount magnetic contacts are designed for use in installations where a small, sealed unit is required. The reed switch is totally encapsulated in an exclusive polyurethane potting compound preventing moisture from entering the switch and causing false alarms.



Specifications

Contact Type: Closed Loop

Contact Rating : Breakdown Voltage 100v / Max.Switch Current 0.5A

Opera. Gap: 20-30mm

Housing: White ,Brown ,Grey ABS

CE,FCC,ROHS recessed mounted switch, ABS case, white or brown color

Loop type	Reed Form	Operation gap(mm)	Max Cur./Vol./Power/Init.Ress(A/VDC/W/m Ω)
Closed	Form A	20-30	0.5A/100V/10W/200m Ω
Open	Form B	20-30	0.2A/30V/3W/200m Ω
COM	NC& NO	20-30	0.2A/30V/3W/200m Ω

* Weight and Size are Only Approximation and May be Modified Without Prior Notification.



Note: Please carefully read User Manual before usage

For detailed specification and functions, please refer to User Manual; in case of inconsistency, the content in User Manual should be kept.

All data and info in the catalog are carefully checked, any mistake resulted from printing and translation can be disregarded. Vians reserves the authority of explanation for its products.

DC101-Series

The DC101-Series surface mount magnetic contacts are designed for use in installations where a small, sealed unit is required. The reed switch is totally encapsulated in an exclusive polyurethane potting compound preventing moisture from entering the switch and causing false alarms.

Specifications

Contact Type: Closed Loop

Contact Rating : Breakdown Voltage 100v / Max.Switch Current 0.5A

Opera. Gap: 1.25 Inch

Lead Wire: Spacers, Cover and Screws Included

Housing: White ,Brown ,Grey ABS

Dimension: 64*19*13mm

Listings: UL ,CE, CUL

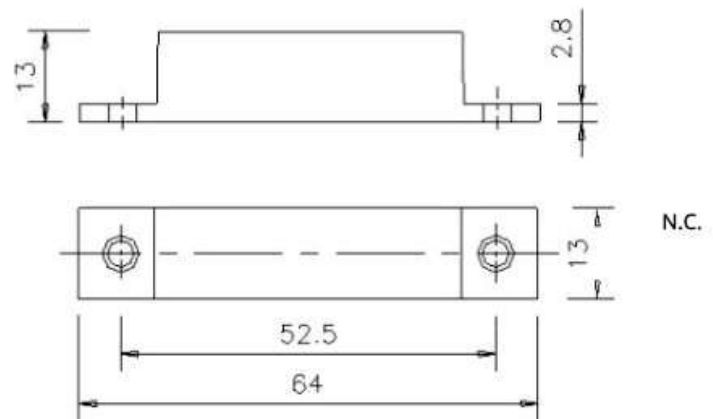
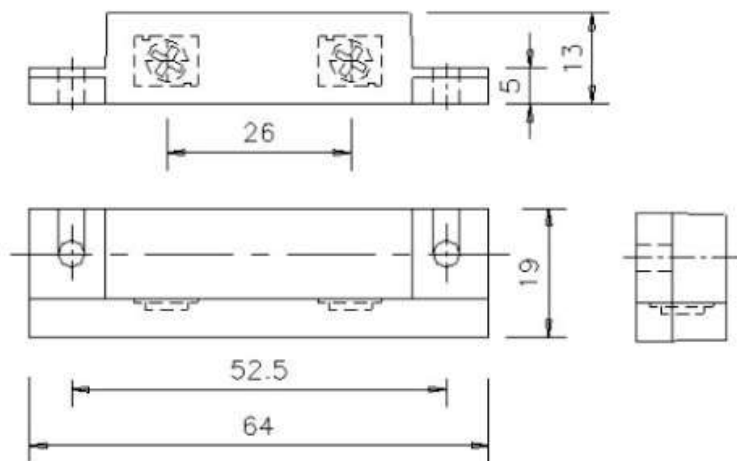

* Weight and Size are Only Approximation and May be Modified Without Prior Notification.



Note: Please carefully read User Manual before usage

For detailed specification and functions, please refer to User Manual; in case of inconsistency, the content in User Manual should be kept.

All data and info in the catalog are carefully checked, any mistake resulted from printing and translation can be disregarded. Vians reserves the authority of explanation for its products.