

PRODUCT DB1260
STANDARD ELECTRIC DROP BOLT MORTISE MOUNT



DB1260

PRODUCT DESCRIPTION

The DB1260 is designed for installation on narrow frame swing doors, and/or glass door mounting. The drop bolt body depth of 35mm will fit into a 44mm depth door frame. The drop bolt is available in either "Power To Lock" or "Power To Release" format.

TECHNICAL DETAILS

PART NO.	DB1260PTO (Power To Release)	DB1260PTL (Power To Lock)
FUNCTION	Slimline mortise mount drop bolt	
HOLDING STRENGTH	Up to 300kg	
VOLTAGE/CURRENT	12-24VDC, 12VDC 1.15A(in-rush) 250mA holding	
APPROVALS	4 hour fire rated to A.S. and B.S. standards	
MONITORING	Door sensor Remote release Bi-coloured LED Audible tone	
ENVIRONMENTAL	L= 210 x W= 25 x D= 35mm	

PRODUCT FEATURES

- Internal control circuits protect drop bolt pin from damage
- Power To Lock or Power To Release (to be specified)
- Auto lock function
- Built-in varistor (MOV) for surge protection
- Time delay setting at 0/3/6/10 secs
- 1 year warranty

PRODUCT DIMENSIONS AND INSTALLATION

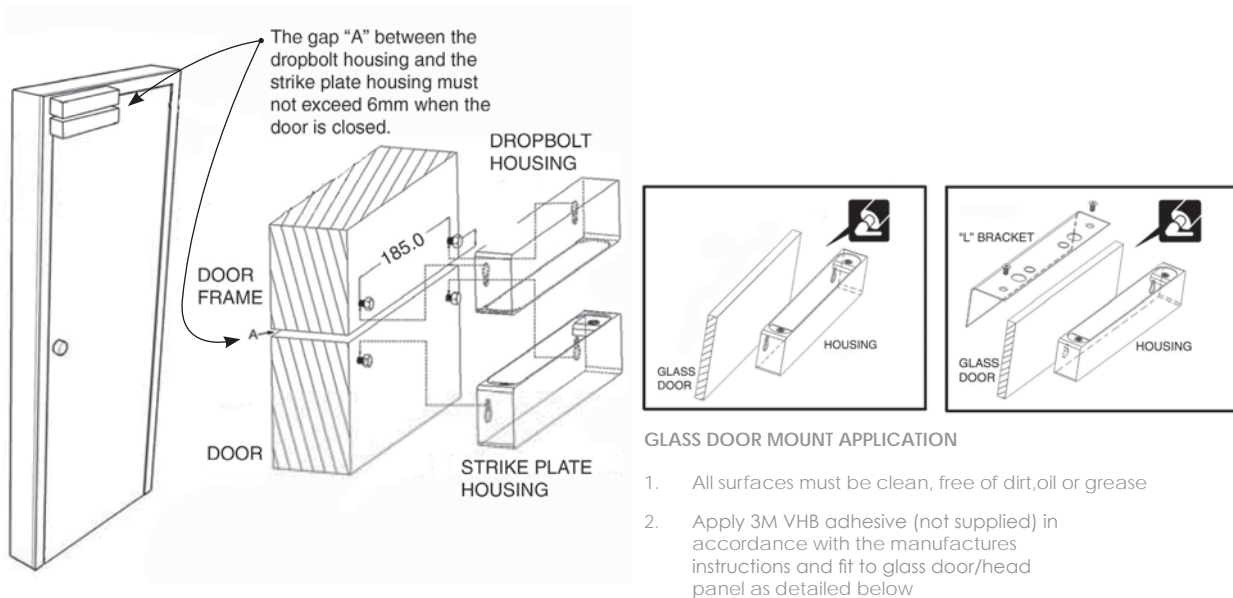

ORDER DETAILS & ACCESSORIES

PART NO.	PRODUCT DESCRIPTION
DB1260	
DB1260PTO	Slimline Drop Bolt Faceplate 25mm round style Power To Release/Open
DB1260PTL	Slimline Drop Bolt Faceplate 25mm round style Power To Lock
DROP BOLT ACCESSORIES	
DB1260BOX	Surface Mount Box for DB1260 Slimline Drop Bolt
DB1260LPLATE	Long Strike Plate for DB1260 Slimline Drop Bolt
DB1260LMAG	L-Glass-Fixing-Bracket for DB1260 with Magnets
DB1260L	L-Glass-Fixing-Bracket for DB1260 without Magnets
UBG-1260L	Glass Patch Fitting with Strike Plate LEFT handed
UBG-1260R	Glass Patch Fitting with Strike Plate RIGHT handed