

DC101-Series

The DC101-Series surface mount magnetic contacts are designed for use in installations where a small, sealed unit is required. The reed switch is totally encapsulated in an exclusive polyurethane potting compound preventing moisture from entering the switch and causing false alarms.

Specifications

Contact Type: Closed Loop

Contact Rating : Breakdown Voltage 100v / Max.Switch Current 0.5A

Opera. Gap: 1.25 Inch

Lead Wire: Spacers, Cover and Screws Included

Housing: White ,Brown ,Grey ABS

Dimension: 64*19*13mm

Listings: UL ,CE, CUL

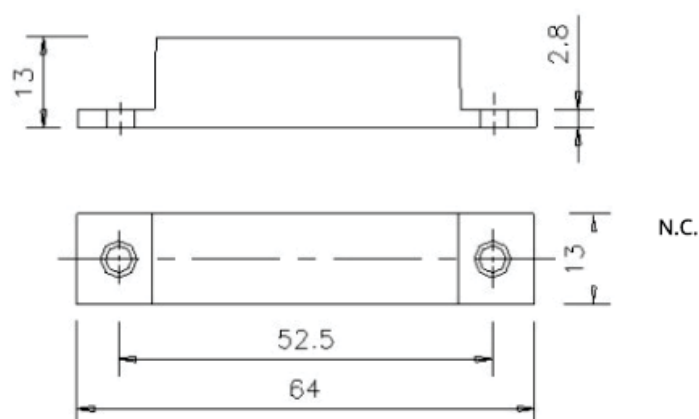
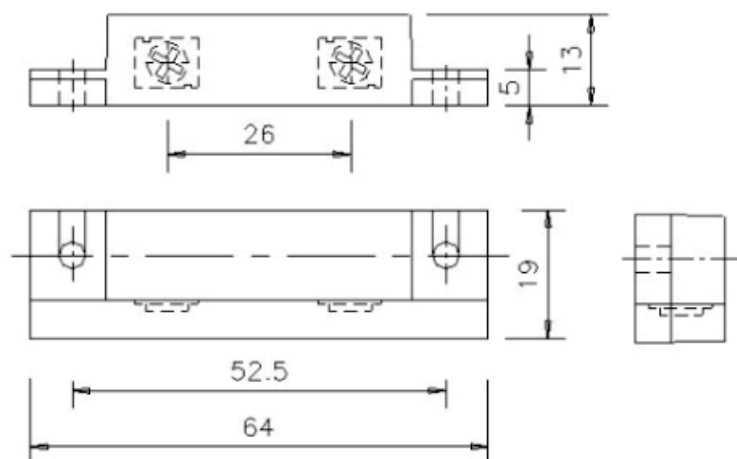

* Weight and Size are Only Approximation and May be Modified Without Prior Notification.



Note: Please carefully read User Manual before usage

For detailed specification and functions, please refer to User Manual; in case of inconsistency, the content in User Manual should be kept.

All data and info in the catalog are carefully checked, any mistake resulted from printing and translation can be disregarded. Vians reserves the authority of explanation for its products.